



Pressure Sustaining Pilot Valve

This is a direct acting valve, actuated by a pressure responsive diaphragm, which tends to reach equilibrium with the set spring force. When used in a pressure relief/sustaining circuit, the pilot modulates open as upstream pressure rises above set point.

Features

- Internal or external pressure sensing
- Differential pressure sensing
- Direct pressure gauge installation

Typical Applications

- Pressure relief/sustaining valve sizes 1 1/2"-4" (Standard model #3PB).
- Differential Pressure sustaining valve sizes 1 1/2"-4" (Modified to differential sensing #3PB-D)

Technical Data

Pressure Rating: 25 bar (350 psi)

Working Temperature: Water up to 80°C (180°F)

Flow Factor: Kv 0.48 (Cv 0.56)

Standard Materials:

Body: Bronze

Cover: Brass

Elastomers: NBR

Internals: Stainless Steel & Brass

Spring: Galvanized Steel

Optional Materials:

Metal Parts: Stainless Steel, Nickel Aluminum Bronze, Hastalloy

Elastomers: FPM (Viton®)

Adjustment Range

Spring	Pressure		
	bar	psi	
M	1-16	15-230	Standard
N	0.8-6.5	11-95	Optional
J	0.2-1.7	3-25	

Connections

- 1 - Remote sensing or pressure gauge
- 2 - Valve control chamber
- 3 - Remote sensing or pressure gauge
- 4 - Downstream

* Upstream pressure is connected to valve control chamber via a restriction.

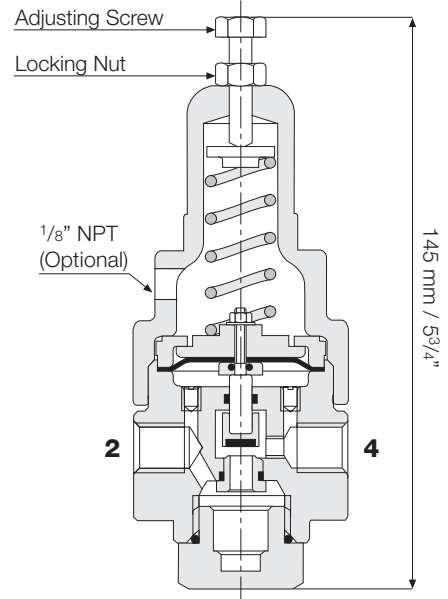
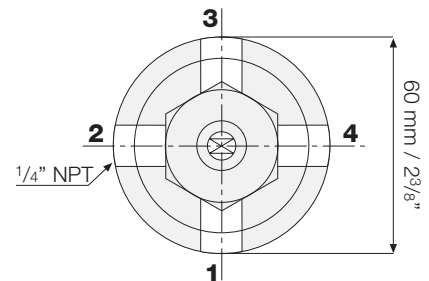

Weight: 1.5 Kg / 3.3 lbs.