

Pitot Tube

When a pitot tube is used as an integral part of a flow control valve control circuit, it provides the differential pressure (ΔP) to power the flow control pilot. A pitot tube flow sensor is recommended for applications where low head loss is essential and required flow is relatively high.

Due to its low ΔP output, a flow control valve with pitot tube (Model 770-j) should employ a high sensitivity pilot.

Technical Data

Material: Brass or Stainless Steel

Sensing ports: 1/8" NPT

Minimum flow velocity: 1.0 m/sec (3.3 ft/sec)



Dimensions

Size		L		W	
mm	inch	mm	inch	mm	inch
40-80	1.5-3	85	3.3	30	1.2
100-300	4-12	115	4.5	30	1.2
350-500	14-20	220	8.7	30	1.2

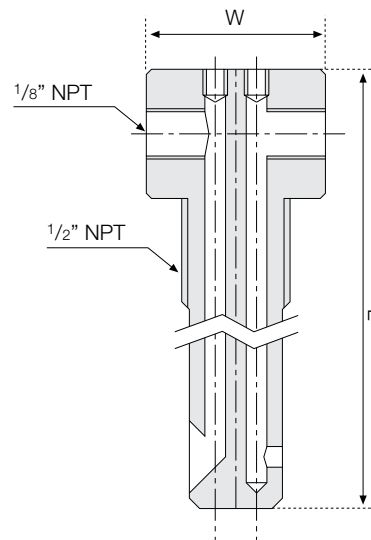

Hydraulic Chart

