



## Pressure Sensing Separation Diaphragm

### Model 35d

This device is used to isolate and protect the pressure sensing chambers of pilots (and pressure gauges) from highly corrosive fluids, high viscosity fluids, or fluids with suspended solids.

It has two chambers separated by a diaphragm. The sensed system pressure is introduced to one chamber, applying force on the diaphragm that "transmits" it to the second chamber. The second chamber and the pilot sensing chamber are connected and are both filled with a non-aggressive, stable fluid.

### Technical Data

**Pressure rating:** 25 bar (350 psi)

**Standard materials:**

**Body:** Stainless Steel 303

**Diaphragm:** NBR, nylon fabric reinforced

**Optional materials:**

**Metal parts:** Stainless Steel 316

**Seals:** FPM

**Ports:** 1/2" NPT

**Air venting ports:** 1/8" NPT

**Maximum temperature:** 80°C (180°F)

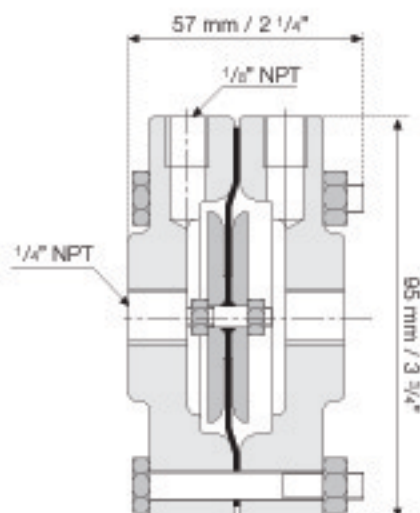

Weight: 2.2 Kg / 4.9 lbs.