

## MONITOR MB3

Monitor in Bronze or corrosion proof light alloy

### Mod. MB3 L - Manual control with lever

#### Standard characteristics

**Body Size:** ~ Ø 95mm (casting)

**Maximum Body Flow Rate:** Max. 4500l/m

**Pressure Loss:** See diagram  $\Delta P$  Vs Flow rate

**Flow rate:** On customer Request link to compatible nozzles or branchpipes

**Flow rate recommended:** See diagram Pressure Loss Vs Flow Rate

**Recommended maximum pressure loss:** 1,2 barg

**Rotation with lever:** 360° continuous

**Elevation and deflection with lever:** ~ +90° - 70°

**Horizontal throw:** See dedicated page on compatible nozzles or branchpipes

**Test Pressure:** 27 barg - **Custom. req.** Up to 48 barg

**Base Flange:** Carbon Steel

**Outlet Flange:** External diameter Ø160 mm

**Coating:** Epoxy Primer + Polyuretanic red coat RAL3000, Total DFT >120 µm

**Weight:** Bronze: ~24Kg - Light alloy: ~10Kg

#### Approvals



MARINE DIVISION

BUREAU  
VERITAS



#### Optional

- > Pressure gauge on outlet
- > Drain Valve
- > Nozzle for thermal irradiation protection
- > Elevation lever with compass system

#### Compatible Nozzles Or Branchpipes

- > Foam and self inducing foam branchpipes mod. LS and LSA
- > Water branchpipe mod. LA
- > Jet spray nozzles mod. Mini GN - GN - Super G
- > Jet spray self inducing nozzles mod. GNA & Super GNA

#### Available on Demand

- > Base Flange: Other material
- > Outlet Flange: Other outlet connection with adaptor (NH, Ghost, Storz)
- > Coating: Other painting cycles

#### Key configuration

- > Application for manual control with double handwheel
- > Application for self-oscillating
- > Application for oil - hydraulic handling

[www.fasspa.net](http://www.fasspa.net)

## MONITOR MB3

Monitor in Bronze or corrosion proof light alloy

### Layout & Overall Dimension - MB3 L Monitor

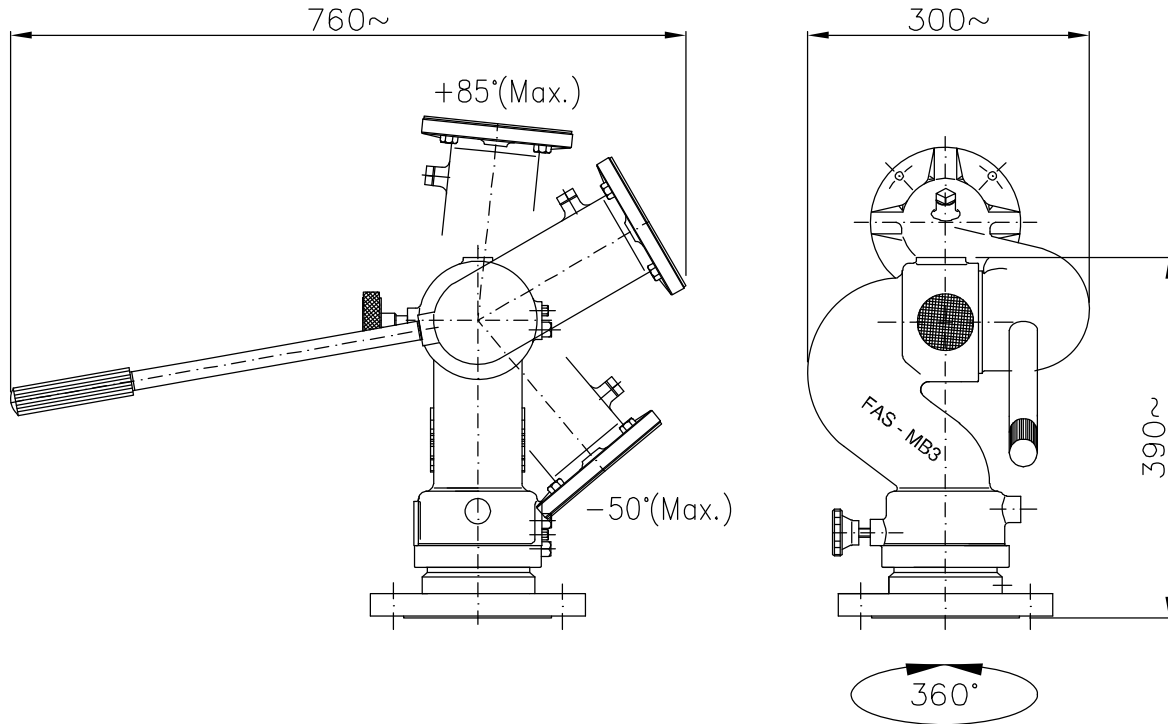

### Pressure Loss $\Delta P$ Vs Flow rate

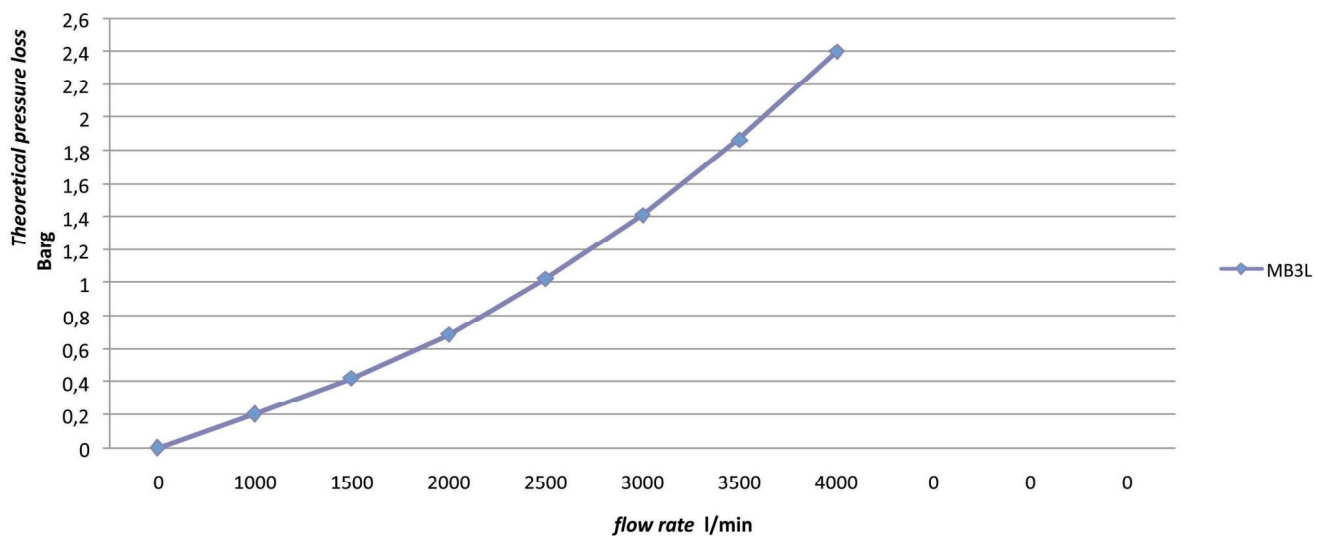

[www.fasspa.net](http://www.fasspa.net)

## MONITOR MB3 KEY CONFIGURATION

Mod. MB3 2V - Application for manual control with double handwheel

### Standard characteristics

**Body Size:** ~ Ø 95mm (casting)

**Rotation with handwheel:** 360° continuous

**Elevation and deflection with handwheel:** ~ +90° - 70°

**Weight:** Bronze: ~30Kg - Light alloy: ~16Kg



MARINE DIVISION

BUREAU  
VERITAS

### Layout & Overall Dimension - MB3 2V Monitor with double handwheel

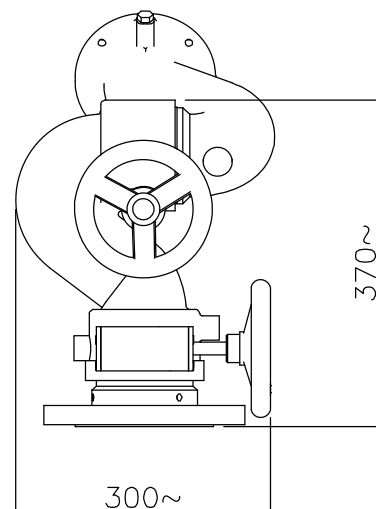
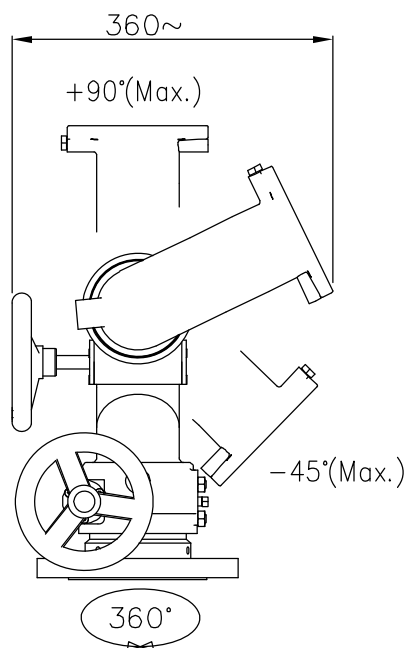

[www.fasspa.net](http://www.fasspa.net)

## MONITOR MB3 KEY CONFIGURATION

Mod. MBA3 L - Application for self oscillating

### Standard characteristics

**Body Size:** ~ Ø 95mm (casting)

**Automatic oscillation with Hydraulic Motor:** 360° continuous, by 30° step

**Elevation and deflection with lever:** ~ +90° - 70°

**Weight:** Bronze: ~51Kg - Light alloy: ~31Kg

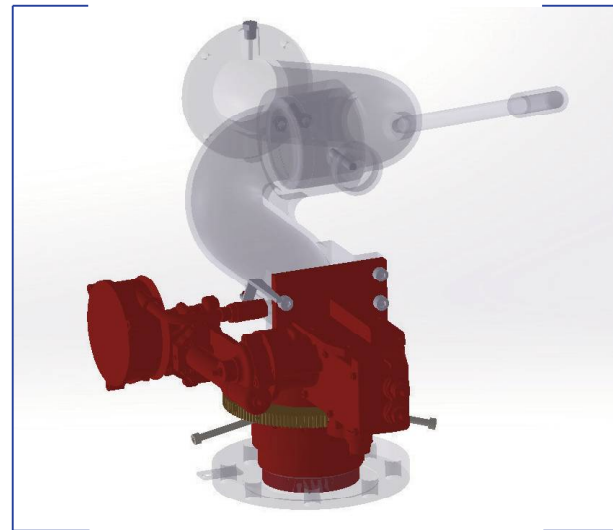

### Layout & Overall Dimension - MBA3 L Monitor self oscillating

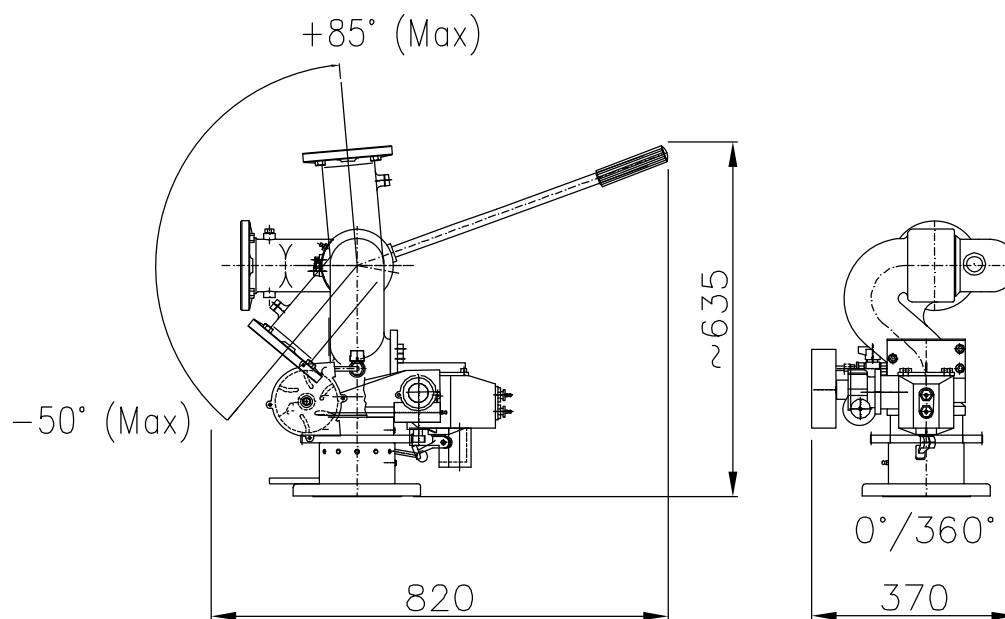

[www.fasspa.net](http://www.fasspa.net)

## MONITOR MB3 KEY CONFIGURATION

### Mod. MBO3 - Application with oil-hydraulic handling

#### Standard characteristics

**Body Size:** ~ Ø 95mm (casting)

**Rotation with Oil Hydraulic Motor:** 360° continuous

**Elevation and Deflection with Oil Hydraulic Motor:** ~ +90° - 70°

**Weight:** for Ø 95mm - Bronze: ~37Kg - Light alloy: ~23Kg

Usable with electric-oil hydraulic mini power pack device  
(see dedicated page)



### Layout & Overall Dimension - MBO3 Monitor with oil-hydraulic handling

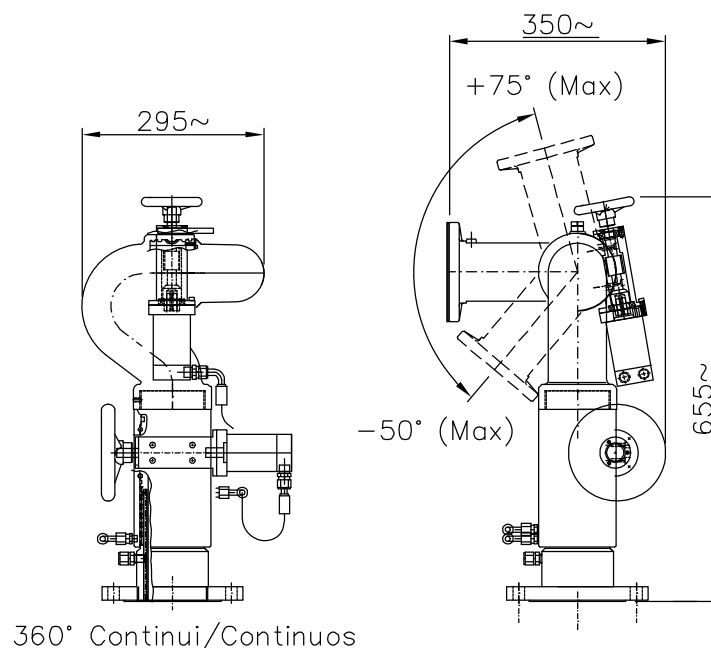

[www.fasspa.net](http://www.fasspa.net)

## MONITOR MB4

Monitor in Bronze or corrosion proof light alloy

### Standard characteristics

**Body Size:** Ø125 mm (casting)

**Maximum Body Flow Rate:** Max. 8600l/m

**Pressure Loss:** See diagram  $\Delta P$  Vs Flow rate

**Flow rate:** On customer Request link to compatible nozzles or branchpipes

**Flow rate recommended:** See diagram Pressure Loss Vs Flow Rate

**Recommended maximum pressure loss:** 1,2 barg

**Rotation with lever:** 360° continuous

**Elevation and deflection with lever:** ~ +90° - 70°

**Horizontal throw:** See dedicated page on compatible nozzles or branchpipes

**Test Pressure:** 27 barg - **Custom. req.** Up to 48 barg

**Base Flange:** Carbon Steel

**Outlet Flange:** External diameter Ø160 mm

**Coating:** Epoxy Primer + Polyuretanic red coat RAL3000, Total DFT >120 µm

**Weight:** Bronze: ~40Kg - Light alloy: ~20Kg

### Optional

- > Pressure gauge on outlet
- > Drain Valve
- > Nozzle for thermal irradiation protection
- > Elevation lever with compass system

### Compatible Nozzles Or Branchpipes

- > Foam and self inducing foam branchpipes mod. LS and LSA
- > Water branchpipe mod. LA
- > Jet spray nozzles mod. Mini GN - GN - Super G
- > Jet spray self inducing nozzles mod. GNA & Super GNA

### Approvals



MARINE DIVISION



### Available on Demand

- > Base Flange: Other material
- > Outlet Flange: Other outlet connection with adaptor (NH, Ghost, Storz)
- > Coating: Other painting cycles

### Key configuration

- > Application for self-oscillating

[www.fasspa.net](http://www.fasspa.net)

## MONITOR MB4

Monitor in Bronze or corrosion proof light alloy

### Layout & Overall Dimension - MB4 Monitor

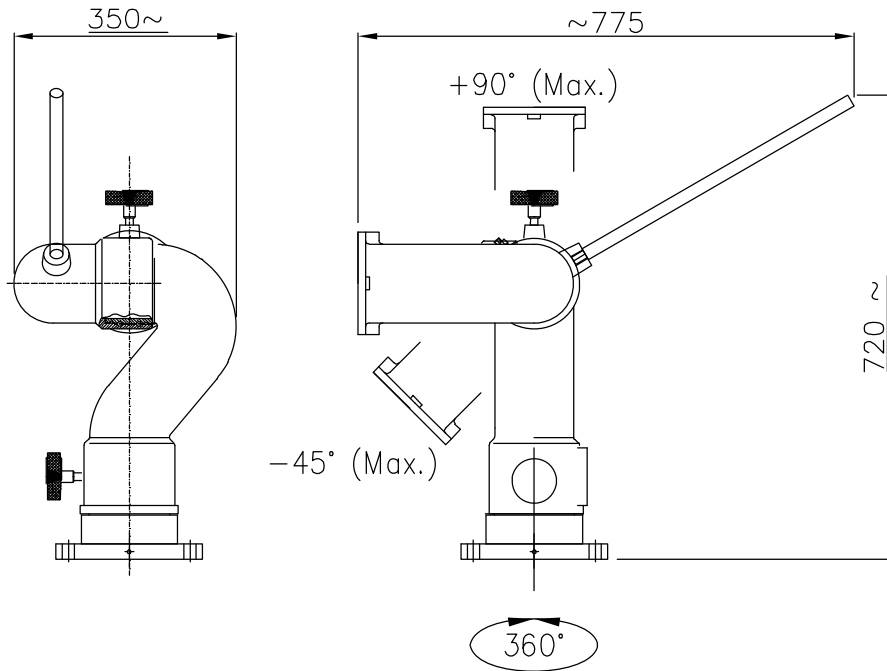

### Pressure Loss $\Delta P$ Vs Flow rate

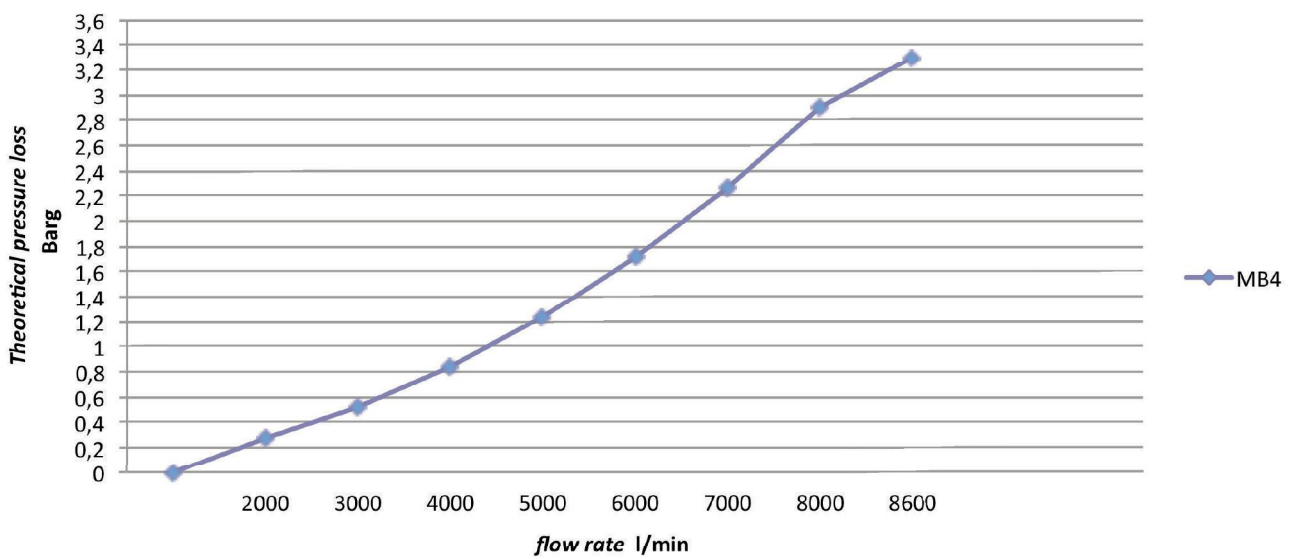

## MONITOR MBA4 KEY CONFIGURATION

Mod. MBA4 L - Application for self oscillating

### Standard characteristics

**Body Size:** ~ Ø 125mm (casting)

**Automatic oscillation with Hydraulic Motor:** 360° continuous, by 30° step

**Elevation and deflection with lever:** ~ +90° - 70°

**Weight:** Bronze: ~81Kg - Light alloy: ~51Kg

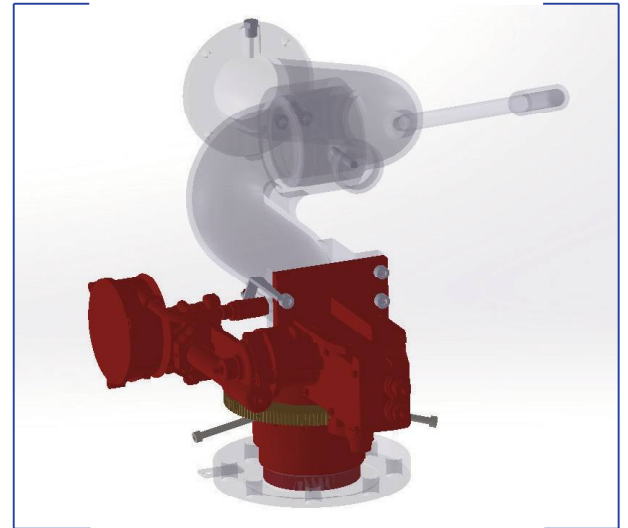

### Layout & Overall Dimension - MBA4 L Monitor self oscillating

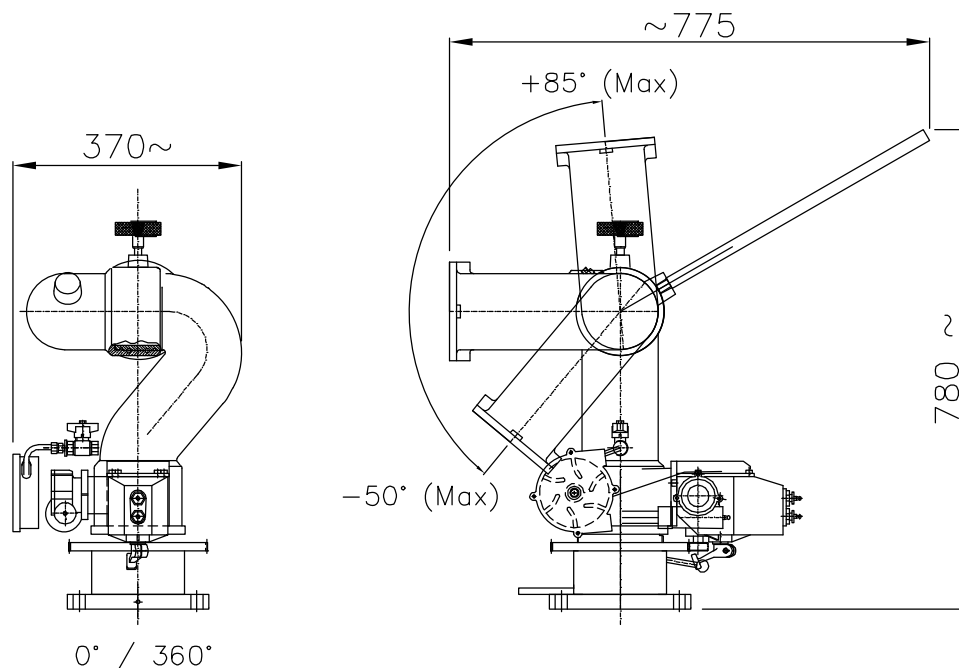

[www.fasspa.net](http://www.fasspa.net)



## MONITOR DOC

Monitor in Bronze or corrosion proof light alloy

### Mod. 2V - Manual control with double handwheel

#### Standard characteristics

**Body Size:** ~ 125 mm (casting)

**Maximum Body Flow Rate:** Max. 8600l/m

**Pressure Loss:** See diagram  $\Delta P$  Vs Flow rate

**Flow rate:** On customer Request link to compatible nozzles or branchpipes

**Flow rate recommended:** See diagram Pressure Loss Vs Flow rate.

**Recommended maximum pressure loss:** 1,2 barg

**Rotation with handwheel:** 360° continuous

**Elevation and deflection with handwheel:** ~ +90° - 70°

**Horizontal throw:** See dedicated page on compatible nozzles or branchpipes

**Test Pressure:** 27 barg - **Custom. req.** Up to 48 barg

**Base Flange:** Carbon Steel

**Outlet Flange:** External diameter  $\varnothing 160$  mm

**Coating:** Epoxy Primer + Polyuretanic red coat RAL3000, Total DFT >120  $\mu\text{m}$

**Weight:** Bronze: ~55Kg - Light alloy: ~32Kg

#### Approvals

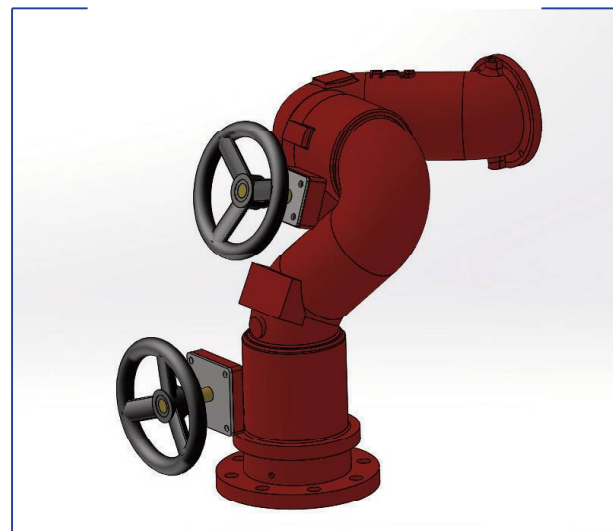

#### Optional

- > Pressure gauge on outlet
- > Drain Valve
- > Nozzle for thermal irradiation protection

#### Compatible Nozzles Or Branchpipes

- > Foam and self inducing foam branchpipes mod. LS and LSA
- > Water branchpipe mod. LA
- > Jet spray nozzles mod. Mini GN - GN - Super G
- > Jet spray self inducing nozzles mod. GNA & Super GNA

#### Available on Demand

- > Base Flange: Other material
- > Outlet Flange: Other outlet connection with adaptor (NH, Ghost, Storz)
- > Coating: Other painting cycles

#### Key configuration

- > Application for electrical handling
- > Application for oil-hydraulic handling
- > Application for self-oscillating

[www.fasspa.net](http://www.fasspa.net)

# MONITOR DOC

Monitor in Bronze or corrosion proof light alloy

## Mod. 2V - Manual control with double handwheel

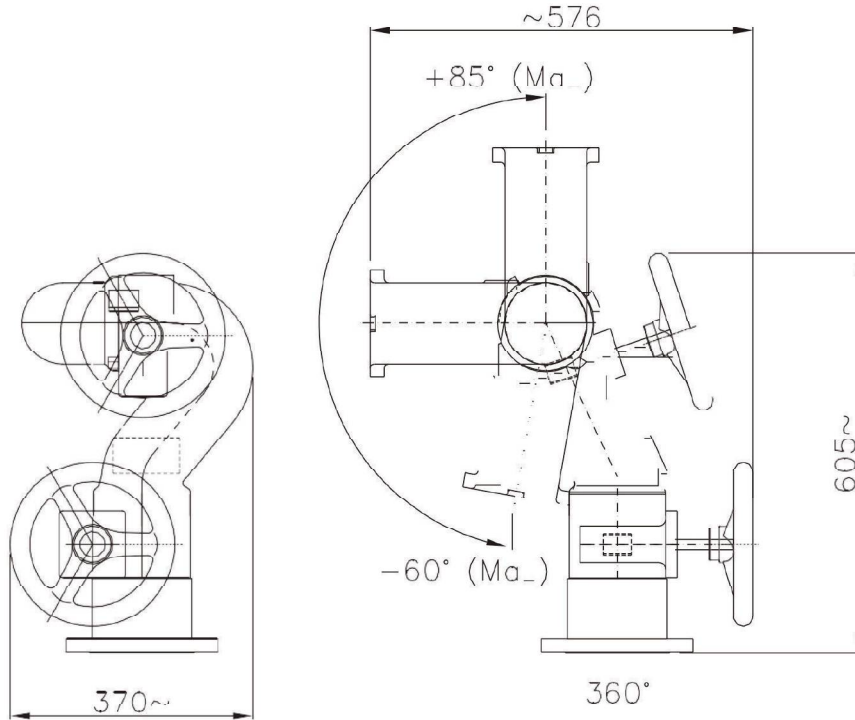

## Pressure Loss $\Delta P$ Vs Flow rate

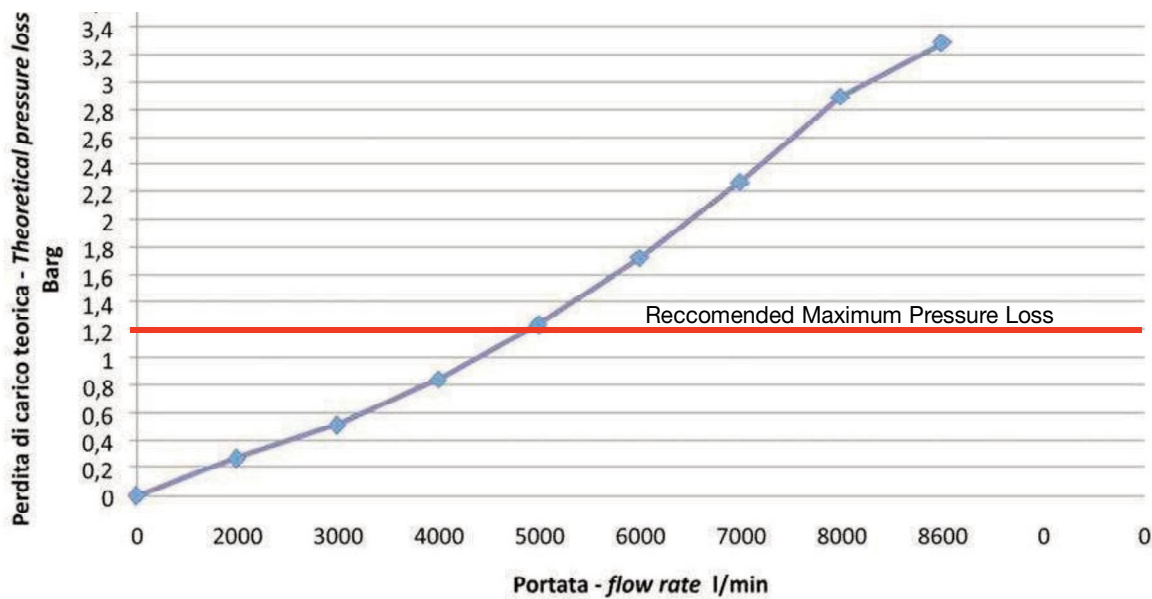

[www.fasspa.net](http://www.fasspa.net)

## MONITOR DOC KEY CONFIGURATION

### Mod. DOC-E - Application for electrical handling

#### Characteristics

**Rotation with electric motor:** From 0° to ± 175° (350° total)

**Elevation and deflection with electric motor:** ~ +90° - 70°

**Weight:** Bronze ~100Kg - Light alloy ~82Kg

**Electric Motor:** Actuator with Limit switch / torque switch integrated

**IP Protection:** IP 66/67

**Custom. req.** ATEX Version - IP68

Nema Protection equivalent (4 or 6P)

**Operational Temp. (for IP):** -25°C + 60°C

**Operational Temp. (for ATEX):** -20°C + 40°C

**Custom. req.** Available other Operational Temp.  
(min: -50°C - Max. + 60°C)

**Feeding Voltage:** 400V AC 50/60Hz. 3ph.

**Custom. req.** Other Feeding Voltage

**Custom. req.** Safety Integrity Level SIL 2 Certification

**Custom. req.** UL Approval

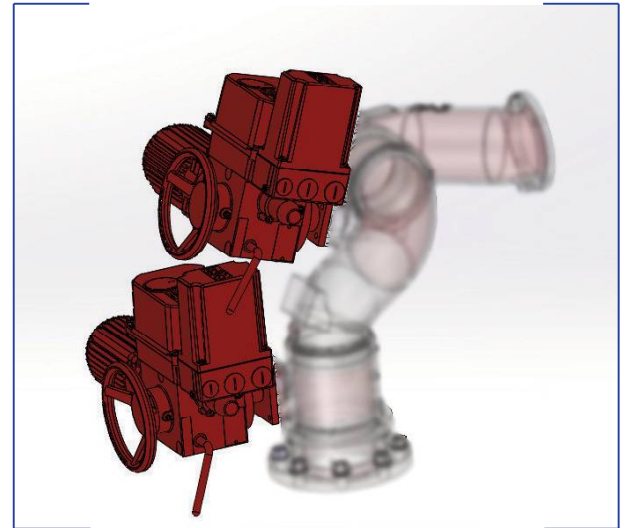

### Layout & Overall Dimension - DOC Monitor with electrical handling

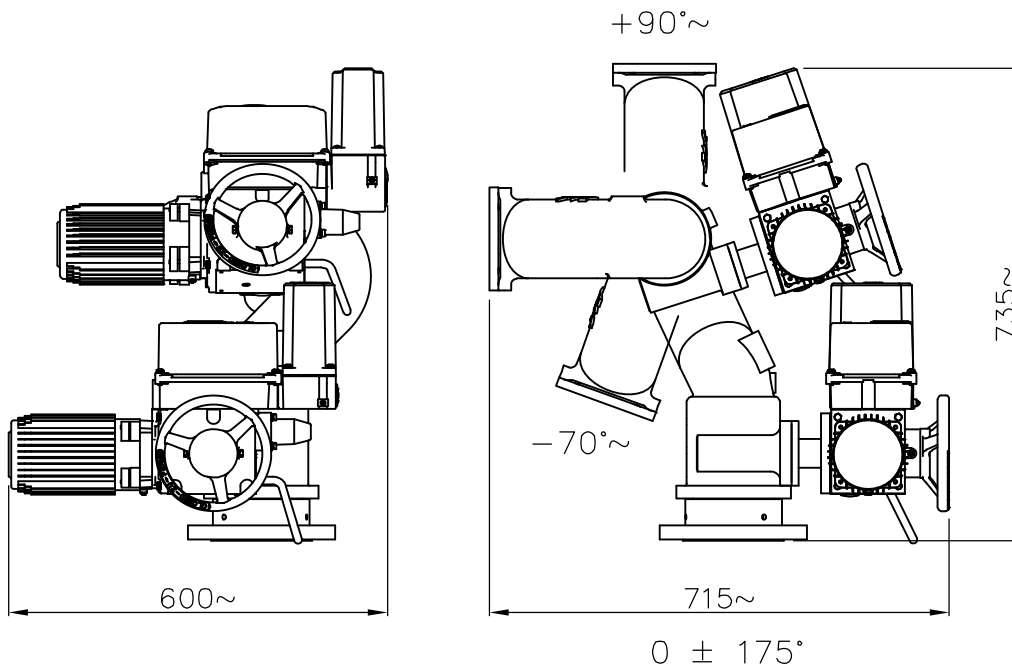

[www.fasspa.net](http://www.fasspa.net)

## MONITOR DOC KEY CONFIGURATION

### Mod. DOC-O - Application for oil-hydraulic handling

#### Characteristics

**Rotation with oil hydraulic motor:** 360° continuous  
(both direction)

**Elevation and deflection with oil hydraulic motor:** ~ +90° - 70°

**Weight:** Bronze ~70Kg - Light alloy ~47Kg

Usable with electric-oil hydraulic mini power pack device  
(see dedicated page)

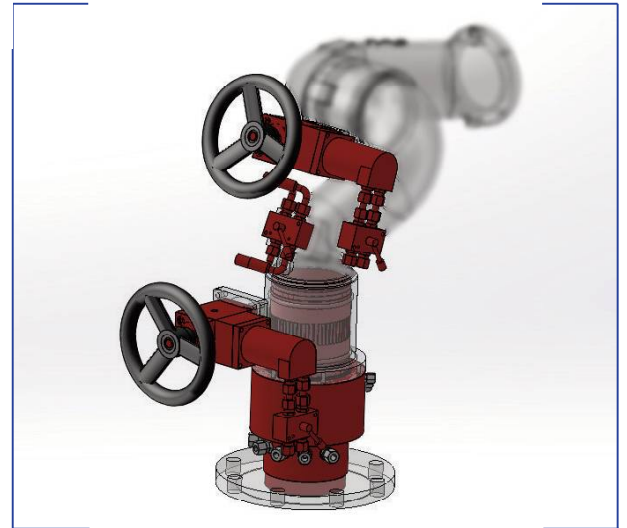

### Layout & Overall Dimension - DOC Monitor with oil-hydraulic handling

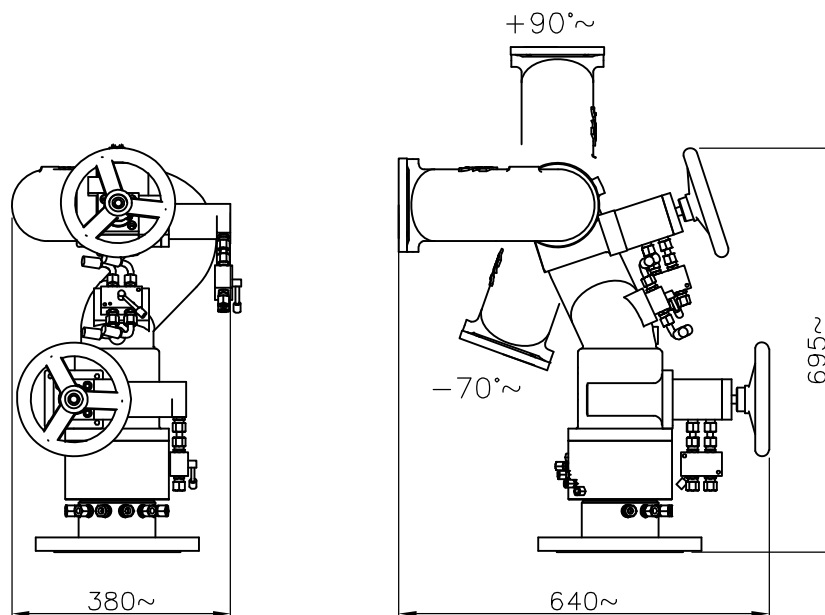

360° CONTINUOUS BOTH DIRECTION

[www.fasspa.net](http://www.fasspa.net)

## MONITOR DOC KEY CONFIGURATION

### Mod. DOC-A - Application for self oscillating

#### Characteristics

Automatic oscillation with Hydraulic Motor with lever for neutral position for manual with handwheel:

360° continuous, by 30° step

Elevation and deflection with handwheel: ~ +90° - 70°

Weight: Bronze ~63Kg - Light alloy ~40Kg

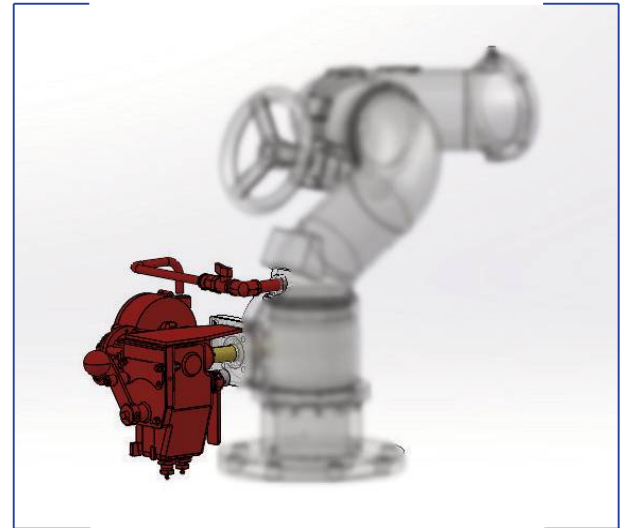

### Layout & Overall Dimension - DOC Monitor self oscillating

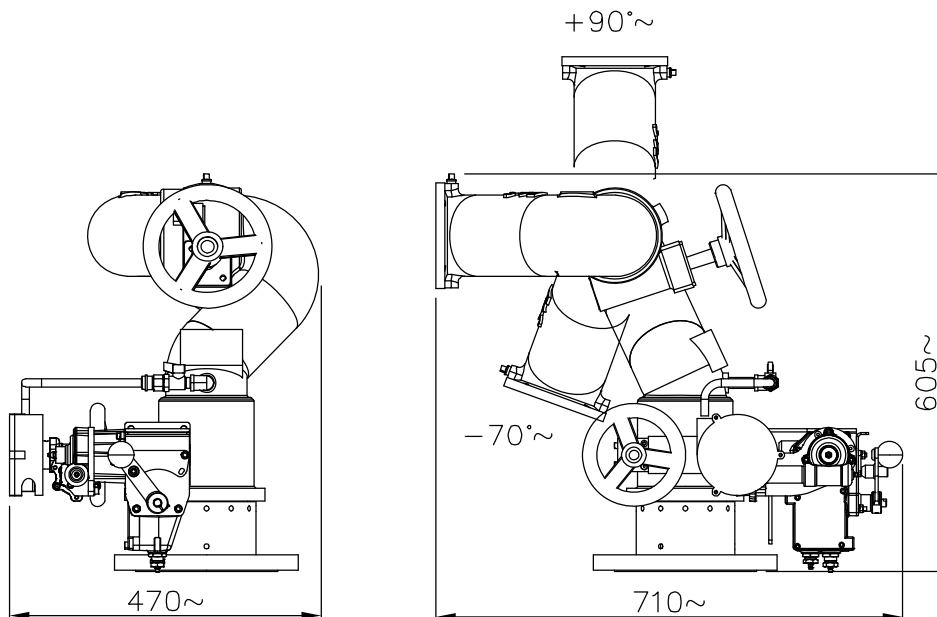

360° CONTINUOUS BOTH DIRECTION  
STEP 30°

[www.fasspa.net](http://www.fasspa.net)