

3-Way Double Chambered High Capacity Accelerator

Model 58HC

This 3-Way, double chambered, high capacity accelerator is a hydraulically operated, diaphragm actuated pilot that, in response to command pressure applied to either the upper or lower control chamber, directs flow and pressure between its ports.

- When forces in the upper control chamber are greater, it connects port "A" to "C."
- When forces in the lower control chamber are greater, it connects port "C" to "O."

This pilot can be used to either relay and accelerate a signal (N.O.), or to reverse and accelerate a signal (N.C.). as a double chambered pilot, it is suitable even when line pressure is very low.

Technical Data

Pressure Rating: 25 bar (350 psi)

Minimum Operating Pressure: 0.2 bar (3 psi)

Working Temperature: Water up to 80°C (180°F)

Flow Factor:

A to C: Kv 3.5 (Cv 4.1)

C to O: Kv 4.6 (Cv 5.4)

Standard Materials:

Body: Bronze

Cover: Brass

Elastomers: NBR

Internals: Stainless Steel & Brass

Optional Materials:

Metal Parts: Stainless Steel, Nickel Aluminum Bronze, Hastalloy

Elastomers: FPM (Viton®)

Connections:

Port	N.O.	N.C.
A	Upstream pressure	Upstream pressure
C	Control chamber	Control chamber
O	Vent	Vent
F/D	Command	Upstream pressure
U	Vent	Command

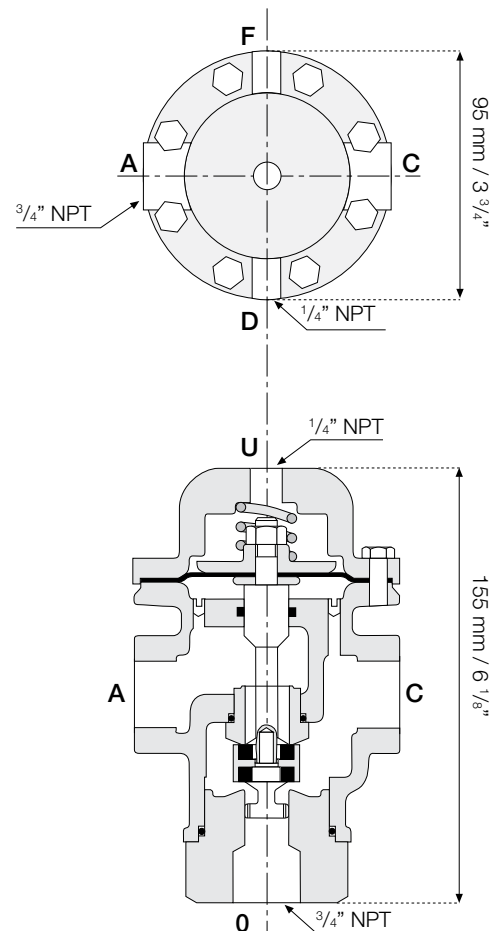

Weight: 3.25 Kg / 7.2 lbs.