



BERMAD Ultrasonic Flow Meter

UFM-10, UFM-30



BERMAD extends its commitment to provide customers with smart metering solutions designed to increase efficiencies, conserve water and improving customer service.

Our Ultrasonic Flow Meter is a state of the art technology ideally suited for all applications. BERMAD's knowledge offers consumers of all types a powerful and unique solution to improve daily operation and meet their business needs.

The no moving parts Ultrasonic Flow Meter maintain its accuracy and efficiency throughout its entire lifetime and eliminate the cost of repairs. Using its integrated intelligence BLE & GPRS communication it enables a constant and secured collection of data remotely enhancing our customers' ability to improve their accuracy, increase metering sensitivity, conserve energy and conversely reduce maintenance and cost.

Features and Benefits

- Integrated intelligence communication - Bluetooth and GPRS
- Replaceable lithium battery pack
- Intuitive Android / iOS App
- No moving parts = No maintenance
- 12 digits LCD display
- Extended low flow accuracy
- Instant installation verification
- Forward and reverse accumulators
- Available in Polymer (UFM-10) and/or Ductile Iron (UFM-30)
- Increases savings with reduced installation and labor costs
- Plug & play installation – minimal piping consideration
- Data logging & remote reading
- Low battery indication
- Flow rate
- Burst detection
- No flow alert
- Tamper indication
- Reverse flow indication
- Time sync
- Over the air programming

Typical Applications

- Computerized Irrigation Systems
 - Irrigation Control HeadIn
 - In-Field Control Head
- Remote Flow Data Read-Out
 - Flow Monitoring & Leakage Control
- Volumetric Irrigation Systems
 - Remote or local monitoring of flows and water usage
- Leak and plugging detection in irrigation systems
- Accumulations of filtration flush water



Dimensions and Weights

Nominal Size	mm	40	50	80	100
	Inch	1½"	2"	3"	4"
L, Length (mm)		300 (422) *	300 (422) *	225	250
H, Height (mm)		161	161	206	215
Weight (kg, cast Iron)		-	9	12	14
Weight (kg, Polymer)		2	2	-	-

* Length including records

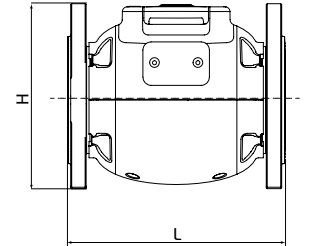
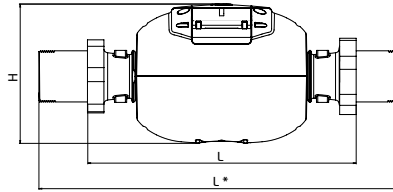

Metrological Data

	Accuracy	mm	40	50	80	100
		Inch	1½"	2"	3"	4"
Qmin (Minimum flow), m³/h	±2%		0.08	0.08	0.126	0.2
Qn ((Nominal flow), m³/h	±2%		40	40	63	100
Qmax (Peak flow), m³/h	±2%		50	50	78.75	125
R (Q3/Q1) *			500	500	500	500
Start Flow			0.01	0.01	0.02	0.02
Max. reading, m³			99,999,999.9999			
Min. reading, liters			0.1			
Kv=Q/√Δp			105	105	158	240
Head loss Δp, bar			0.16			

* R = Qn/Qmin

UFM Flow Chart

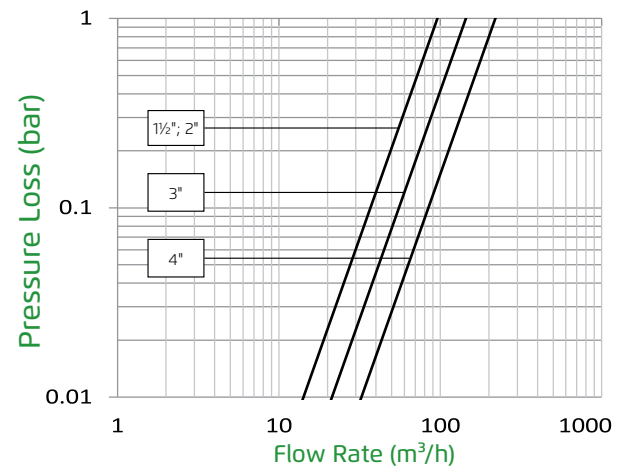

Applicable Icons

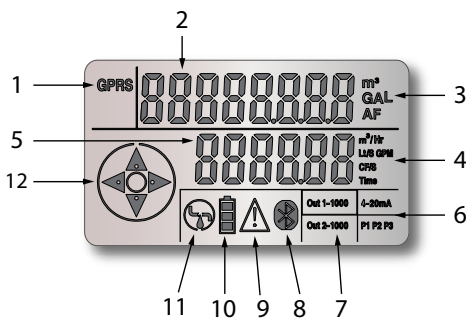

1. GPRS Communication
2. Volume
3. Volume Units
4. Flow Rate Units
5. Flow Rate
6. Outputs
7. Pulse Rates
8. BLE Communication
9. General Warning
10. Battery Level Indication
11. Leakage Alert
12. Volume Direction

Application

